

AUGUST®

User Manual

MR260



August International Ltd

Rawmec Business Park
Hoddesdon EN11 0EE

United Kingdom

T: +44(0) 845 250 0586

(Carrier Rates Apply)

E: service@augustint.com

EU Distributor:

Daffodil Germany GmbH

Bayernstr. 10

D-30855 Langenhagen

Germany

T: +49 (0) 511 97812978

www.augustint.com

- | | |
|-----------|--|
| EN | Dual Mode Bluetooth Transmitter & Receiver |
| FR | Transmetteur & Récepteur Bluetooth Double Mode |
| DE | 2-in-1 Bluetooth Transmitter und Receiver |
| IT | Trasmettitore & Ricevitore Bluetooth |
| ES | Transmisor & Receptor Bluetooth 2 en 1 |
| PL | 2 w 1 Nadajnik i Odbiornik Bluetooth |
| RU | 2 в 1 передатчик и приёмник Bluetooth |
| CN | 二合一蓝牙接收&发射器 |
| JP | 2in1 Bluetooth受信機 & 送信機 |

User Manual

Thank you for purchasing the August MR260 Bluetooth Transmitter. This user manual is designed to familiarize you with all the features of this device. Please take the time to read this user manual carefully, even if you are already familiar with a similar product.

Safety

To ensure the safety of you and others, please read the Safety Instructions before using this device. Please do not disassemble the product, it can be unsafe and will invalidate the manufacturer's warranty.

Disposal

Please ensure the product and accessories are disposed of in compliance with the WEEE (Waste Electrical and Electronic Equipment) Directive and any other regulations applicable to your country. Always check with the environment agency and any other relevant authorities for current disposal regulations.

Declaration of Conformity

The Declaration of Conformity can be found on our website at <http://augustint.com/en/declaration/>

Customer Service

You can contact us by phone on: +44(0)845 250 0586 (Carrier Rates Apply) or by email at: service@augustint.com should you require further technical support or customer service.

1. Safety Instructions

- 1) Do not use this device near water.
- 2) Clean only with a dry cloth. Switch this product off before cleaning.
- 3) Do not install near any heat sources such as stoves or other apparatus that produce heat.
- 4) Only use the accessories supplied by the manufacturer.
- 5) Do not open the device, as this will invalidate the warranty.

2. Main Features

- Dual Mode Bluetooth Transmitter / Receiver
- AptX Low Latency Technology for lag free music and movie
- Standard 3.5mm Audio Socket
- Built-in Rechargeable Battery
- Distance: up to 10m (Class II)
- Bluetooth Profiles: A2DP, AVRCP, PBAP

3. Box Contents

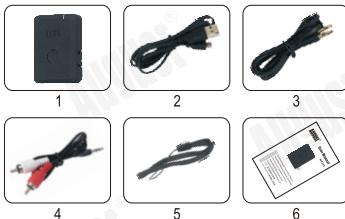

- 1) Dual Mode Bluetooth Transmitter / Receiver
- 2) USB-C Power Cable
- 3) 3.5mm Audio Cable
- 4) 3.5mm to 2xRCA Audio Cable
- 5) Lanyard
- 6) User Manual

4. Part Names & Functions

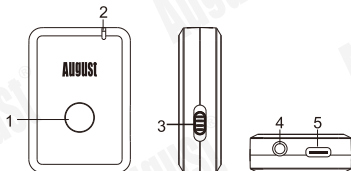

- 1) Multi-Function Button
- 2) Status LED
- 3) Receiver (RX) and Transmitter (TX) Mode Switch
- 4) Aux In / Out
- 5) Power Socket

5. Operations

5.1 Transmit Audio (TX Mode)



- 1) Select TX mode. The MR260 will enter reconnection mode automatically and will connect automatically to any previous known device. To pair to a new device, press and hold the multi-function button for 4 seconds to enter pairing mode. In pairing mode the status LED will flash red and blue alternately.

- 2) Enable Bluetooth on the receiving device and enter pairing mode (see the device's user manual for more information).

The MR260 will pair automatically to the receiving device.

Once successfully paired, the status LED will light blue constantly.

- 3) To pair to a new device, press and hold the multi-function button for 4 seconds to switch the MR260 into pairing mode again. This can be done either when a device is already connected to the MR260 or when the MR260 is in reconnection mode. In pairing mode, the status LED will flash red and blue alternately.

Note: When the receiving device is switched off, the MR260 will enter reconnection mode. The LED will flash blue twice per second and the MR260 will reconnect to any previously paired device that is in range and has Bluetooth switched on.

5.2 Receive Audio (RX Mode)

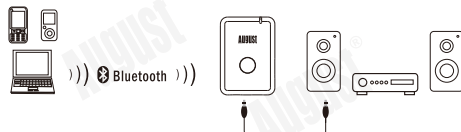

- 1) Select RX mode. The MR260 will enter reconnection mode and will connect automatically to any previous known device. If no known device is available, the MR260 will automatically enter pairing mode after 4 seconds and the status LED will flash red and blue alternately.
- 2) Enable Bluetooth on the source device

- 3) Scan for Bluetooth devices on your source device and select MR260 to connect to it.

Once successfully paired, the status LED will flash blue every 4 seconds.

- 4) To pair to a new device, press and hold the multi-function button for 4 seconds to switch the MR260 into pairing mode again. This can be done either when a device is already connected to the MR260 or when the MR260 is in reconnection mode. In pairing mode, the status LED will flash red and blue alternately.

Note: When the source device is switched off, the MR260 will enter reconnection mode. The status LED will flash blue twice per second and you will be able to reconnect to any previous paired device. For Android source devices, the MR260 will reconnect automatically, for all other devices select the MR260 from their Bluetooth device list.

For PC connections, Windows XP and Windows Vista require third party software to connect to Bluetooth speakers. If you are using a later version of Windows and the MR260 is not outputting audio, please check that the drivers for your PCs Bluetooth module are up to date and that the Audio Output source is set to the MR260.

5.3 Multi-Function Button

Whilst connected in either TX or RX Mode, press the multi-function button to mute or unmute the MR260.

When connected to a device or in reconnection mode, press and hold the multi-function button for 4 seconds to reset the connection and enter pairing mode again. The status LED will flash red and blue alternately and you will be able to connect the MR260 to a new device.

6. Charging

Connect the MR260 to a powered USB port using the provided USB charging cable.

While charging, the status LED will light red and go off once the battery is fully charged.

A full charge takes approximately 1.5 hours depending on power input.

7. Specifications

Bluetooth version	V5.2
Bluetooth frequency	2402-2480mHz
Bluetooth distance	Up to 10M
Bluetooth audio technology	SBC, APTX, APTX-LL
TX/RX mode interface	Aux
Battery	200mAh
Charging time	about 1.5H
Work time	13H
Charging interface	Type-C 5V
Product size	50(L)×13.7(H)×35(W)mm
Product weight	18g

8. Troubleshooting

Problems	Possible Causes and Solutions
Unable to switch on	<ul style="list-style-type: none"> • Fully charge the MR260 • Turn switch on TX or RX
Unable to pair Bluetooth source device or Bluetooth audio device	<ul style="list-style-type: none"> • Confirm that the MR260 is in pairing mode. • Confirm that the MR260 is within 10m of the source device or audio device. • Delete existing connection to MR260 from source device and repair.
Can't install the driver for MR260 on a computer	<ul style="list-style-type: none"> • For Windows 7 and 8, update the Bluetooth driver from the Bluetooth module manufacturer's website. For further information on you PCs Bluetooth module, please consult your PC supplier. • Bluetooth headsets are not supported by Windows XP and Vista, a third party Bluetooth driver can be used to solve this issue.
There is no sound from my Bluetooth audio device	<ul style="list-style-type: none"> • Make sure the Bluetooth audio device is connecting to MR260 via Bluetooth. • Make sure the cable is connection between your source device and MR260. • Check the volume on both source device and your Bluetooth audio device.

9. Warranty

This product is guaranteed for twelve months from the date of the original purchase. In the unlikely event of any defect arising due to faulty materials or workmanship, the unit will be either replaced or repaired free of charge (where possible) during this period. An alternative product will be offered in case the product is no longer available or repairable.

This warranty is subject to the following conditions:

- The warranty is only valid within the country where the product is purchased.
- The product must be correctly installed and operated in accordance to the instructions given in this user manual.
- The product must be used solely for domestic purposes.
- The warranty only covers the main unit, and does not cover the accessories.
- The warranty does not cover the damage caused by misuse, negligence, accident and natural disaster.
- The warranty will be rendered invalid if the product is resold or has been damaged by inexpert repairs. The manufactures disclaim any liability for incidental or consequential damages.
- Please consult our customer adviser before returning any product; we are not responsible for any unexpected product returns.

- Any faulty product must be kept and returned in the original packaging with all the accessories and the original copy of the purchase receipt.

The warranty is in addition to, and does not diminish, your statutory or legal rights.

Customer Service:

Telephone: +44 (0) 845 250 0586 (Carrier Rates Apply)

Email: service@augustint.com

This product is in compliance with the essential requirements and other relevant provisions of Directive 2014/53/EU. The Declaration of conformity may be consulted online at <http://www.augustint.com/en/declaration>.

